

The image shows the exterior of The Ardilaun Hotel. The name "THE ARDILAUN HOTEL" is prominently displayed in large, dark, serif capital letters on a light-colored stone or concrete facade. Above the name, there are two ornate, black lantern-style light fixtures. Below the name, the entrance features a large glass door with a dark wood frame. The building has a classic architectural style with a gabled roof and a balcony area above the entrance. The sky is a clear, bright blue. In the foreground, there are some out-of-focus green and yellow plants.

THE ARDILAUN HOTEL

meetings, conferences and events

all your corporate needs catered for at one comfortable and convenient location





THE ARDILAUN

Est. 1962

ARDILAUN'S JOURNEY

The Ardilaun Hotel, or 'Glenarde House' as it was then known, was built circa 1840 as a townhouse for the Persse Family who had large estates in South Galway. One of the Persse Family became Lady Gregory, Co-Founder of the Abbey Theatre. In 1922 the residence at Glenarde was sold to Mr. Patrick Boland – the Boland biscuit making family. The Bolands lived at Glenarde until 1961 when the property, with five acres, was acquired by Mr. and Mrs. Patrick D. Ryan and its conversion into a hotel commenced.

The Ardilaun Hotel was opened for business on St Patrick's Day in 1962 – it was a small hotel at that time, known then as 'The Ardilaun House Hotel'.

Over the years, major investment has led to the hotel as it currently stands with 123 Bedrooms, Conference and Event Facilities, Bar and Bistro, Camilaun Dining Room, Guest Lounges, Superb Leisure Club, Beauty Salon, Beautifully Landscaped Gardens and Complimentary Convenient Car Parking.

The Ardilaun (as it has been known for decades by locals and regular guests) is set in unique seclusion while, at the same time, is very convenient to Galway city centre.

Since 1962 the hotel has been owned and managed by the Ryan family. John Ryan is the Managing Director of the hotel and, together with the proud Ardilaun team of over 120 staff, provides a very high standard of quality and service in a most friendly and efficient manner to all those who visit this well loved hotel.

CONTENT

Ardilaun's Journey	02
Why Galway? Why The Ardilaun?	03
What Our Guests Say	04
Ground Floor Plan	05
First Floor Plan	06
Connacht Suite	07
Glenarde Suite	08
Aran Room	08
Tetrarch Suite	09
Kilronan Room	09
Ballycurran Room	10
Boardroom	10
Dun Aengus Room	11
Meeting Room Set-Up Styles	11
Accommodation	12
Dining	13
Leisure Club	14
Beauty Salon	14

WHY GALWAY?

- City, Sea and Lake
- Gateway to Connemara
- Wild Atlantic Way
- Atmosphere
- Activity
- Theatres
- Shopping
- Nightlife
- Culture
- Restaurants
- Great Beaches
- Salthill Promenade

WHY THE ARDILAUN?

- The People
- Reputation
- Comfort
- Luxury 4* Hotel
- 123 Guest Bedrooms
- Meeting Facilities for up to 600 Delegates
- Banqueting Facilities for up to 380 Guests
- Superb Leisure Club
- Beauty Salon
- Full Accommodation Services
- Array of Dining Options
- Beautiful Grounds (Suitable Teambuilding/BBQs)
- Complimentary Convenient Car Parking
- Complimentary Wireless Internet Access
- Warm and Friendly Welcome
- Helpfulness, Care and Attention Guaranteed
- Professionalism
- Efficiency
- Host Site Inspections
- Detailed Quotations Provided Promptly
- Complimentary equipment provided (Ask for details)
- Full Supplier Listing Provided (AV, Entertainment etc.)

WHAT OUR GUESTS SAY

We have very much enjoyed our stay in the Ardilaun hotel. Preparations for the conference as well as the service during the conference were top quality. Every member of staff (managers, reception, restaurant and bar staff) were very friendly. We have organised with our organisation conferences around the world, but the friendliness and helpfulness of the Irish people is unmatched. We really hope to come back to drink a good Guinness (or two).

Thanks again for our pleasant stay in your hotel.

*International Society for Military Law
and the Law of War, Belgium*

Finally, responding to you all in gratitude for a very enjoyable stay at the Ardilaun Hotel at our NEC Executive Meeting.

Can I express my sincere thanks to all of the staff who made our stay a comfortable and an enjoyable time and that was echoed by all of the NEC IPA Executive.

Gratitude to Mr John Ryan, Manager for making me personally feel so welcome. I appreciate all your kind gestures, not to mention my bedroom which was a real treat. I enjoyed its surrounding very much and admired its simplistic interior design. All of the Executive spoke very highly of the quality of their individual bedrooms.

With very Kind Regards and Best Wishes.

NEC – IPA Ireland

Sorry I missed you yesterday. We had a lovely day, everyone seemed to enjoy the whole day. The President and her husband enjoyed their lunch and few minutes free time..

Thank you for all your assistance and please pass on my sincere thanks to John who looked after everyone very well.

*Protocol Officer to the President
Áras an Uachtaráin, Éire*



Thanks for all of your help with our event – I have worked with quite a few hotels for various events and it really helps me enormously when dealing with such helpful, professional and lovely people like yourselves.

This is just a little note to say thank you once again for all your hard work and help you have given with all the arrangements for our customer event. It really was a pleasure working with you and all of the staff at the hotel. Everyone had a brilliant time and the event was a total success.

The hotel really stands out in my mind as one of the best I have ever worked with – everyone was so accommodating with all of our requests. It was all the hard work that was put in beforehand that ensured the smooth running of the event, so thanks again!

Wallenius Wilhelmsen Logistics, UK

Just a note to thank you and your team for a fantastic service on Friday night for the retirement function. It was a great night due in no small way to the care and attention given to us by all in The Ardilaun. The food was superb and commented on by numerous people at the function. Your duty manager was really great and so helpful on the night. Please pass on our thanks to all the staff who worked to make it such a great success – thanks for making our job very easy.

University College Hospital, Galway, Ireland

On behalf of the members Galway Salthill Rotary Club and the Conference Committee, I wish to express our sincere appreciation for your excellent support in making the conference such a huge success. We have received numerous compliments praising the conference and stating that it was one of the best if not the best they have attended.

The success of the conference was in no small measure due to the support we received from each and every member of The Ardilaun management and staff. Your professionalism and attention to detail combined with the heart felt welcome of the hotel and its history was the perfect setting for this conference.

May I once again express our appreciation and we look forward to many more years of the association between The Ardilaun Hotel and Galway Salthill Rotary.

President, Galway Salthill Rotary Club, Ireland

GROUND FLOOR

The Ardilaun Hotel is situated in the quiet location of Taylors Hill. It is ideally positioned on its own grounds offering plenty of complimentary parking, some of which can be secured overnight. Whilst away from the hustle of Galway City, the hotel is still close enough to allow guests and visitors conveniently avail of the city's many amenities.



FIRST FLOOR

The Ardilaun Hotel is ideal for you should you require a large conference venue or a smaller, more intimate, meeting room. The versatility of The Ardilaun can host any event type to include a large dinner with entertainment, charity event, fashion show, product launch or exhibition.

All of the Ardilaun's meeting rooms have natural daylight and are located close to the main foyer of the hotel. This makes it ideal for networking during coffee breaks.

Complimentary Wi-Fi is offered throughout the hotel - in meeting rooms, bedrooms and public areas.



CONNACHT SUITE



THEATRE	600	EXAM	100
BOARDROOM	80	RECEPTION	550
CLASSROOM	220	CABARET	230
U-SHAPE	65	SEMI- CIRCLE	120
BANQUET	380	CIRCLE	80

DIMENSIONS

Room Area 23.0m X 16.2m
 Ceiling Height 4.24m
 Door Height 2.23m
 Door Width 1.55m

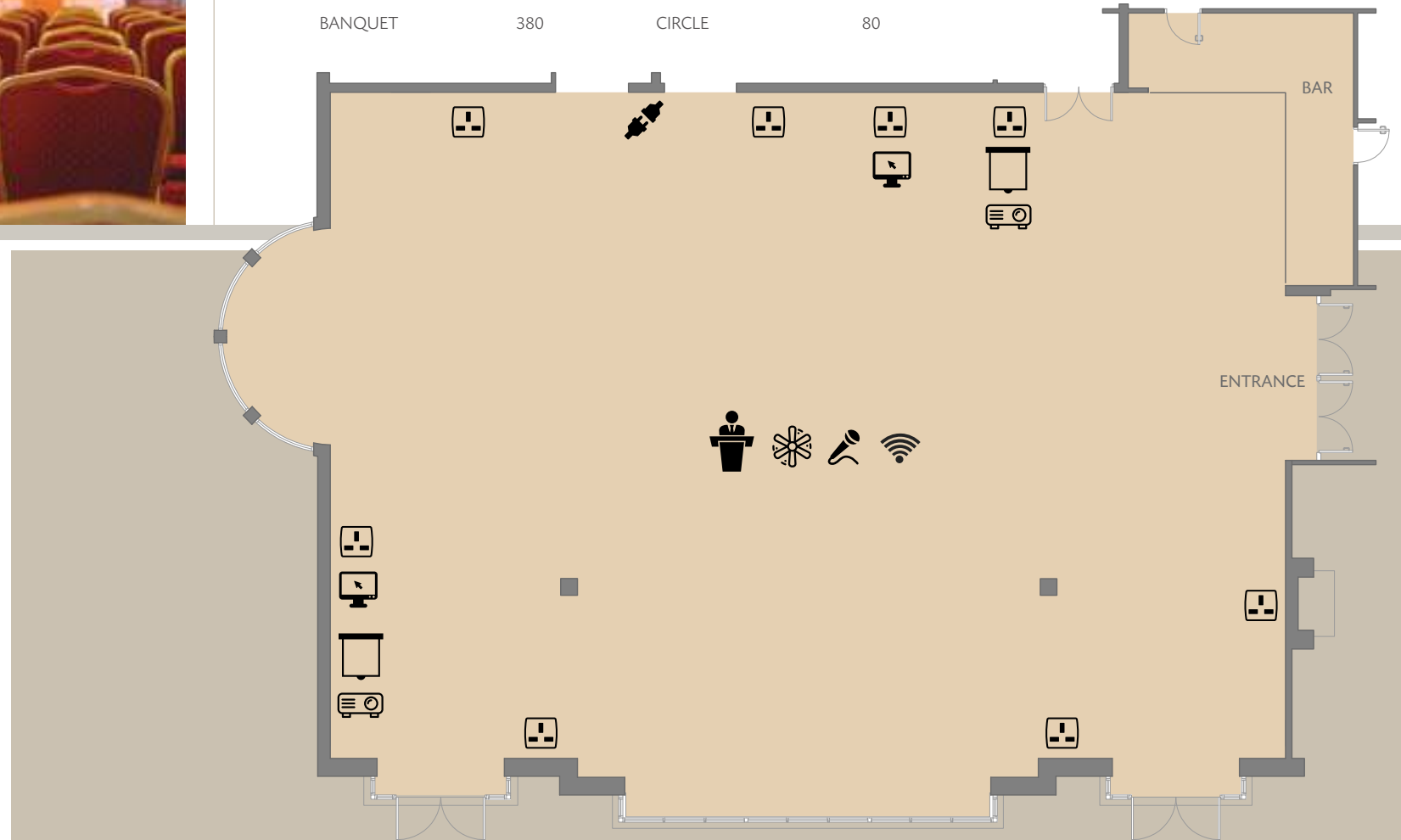

KEY TO SERVICES

- SCREEN
- LCD PROJECTOR
- PHONE LINE
- PODIUM
- AIR CONDITIONING
- 3 PHASE POWER
- POWER SOCKETS
- WIFI WIRELESS BB
- MIC / AUDIO
- PC PORT

GLENARDE SUITE

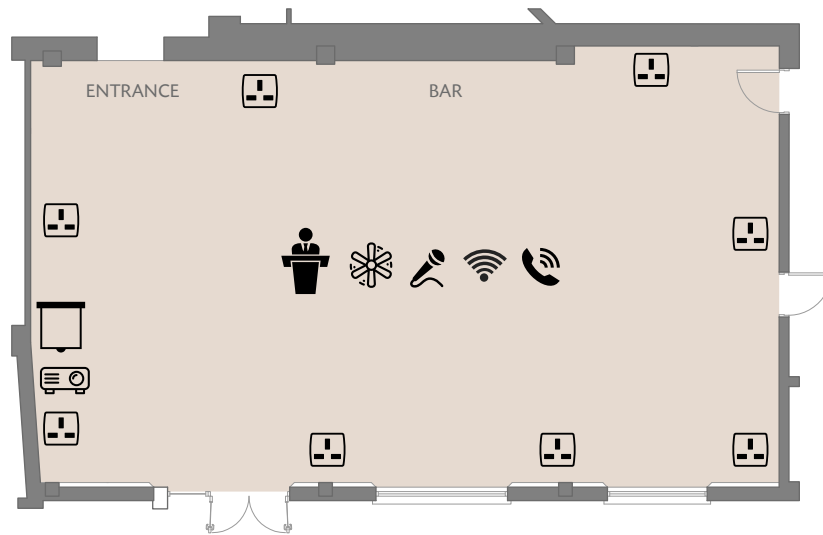

THEATRE	170
BOARDROOM	50
CLASSROOM	80
U-SHAPE	45
BANQUET	130
EXAM	40
RECEPTION	150
CABARET	70
SEMI-CIRCLE	70
CIRCLE	50

DIMENSIONS

Room Area 16.0m X 9.0m
Door Height 2.23m

Ceiling Height 2.75m
Door Width 1.43m



ARAN ROOM

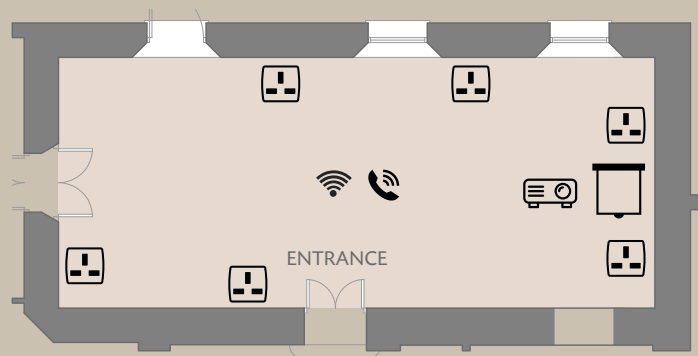

THEATRE	80
BOARDROOM	40
CLASSROOM	35
U-SHAPE	36
BANQUET	50
EXAM	20
RECEPTION	70
CABARET	30
SEMI-CIRCLE	40
CIRCLE	40

DIMENSIONS

Room Area 12.3m X 5.4m
Door Height 2.02m

Ceiling Height 3.25m
Door Width 0.89m



TETRARCH ROOM



THEATRE	66
BOARDROOM	30
CLASSROOM	30
U-SHAPE	32
BANQUET	N/A
EXAM	16
RECEPTION	40
CABARET	24
SEMI-CIRCLE	30
CIRCLE	30

DIMENSIONS

Room Area 9.3m X 6.0m Ceiling Height 2.63m Door Height 2.02m Door Width 0.76m



KILRONAN ROOM

DIMENSIONS

Room Area 7.3m X 6.0m Ceiling Height 2.61m
 Door Height 2.02m Door Width 0.74m

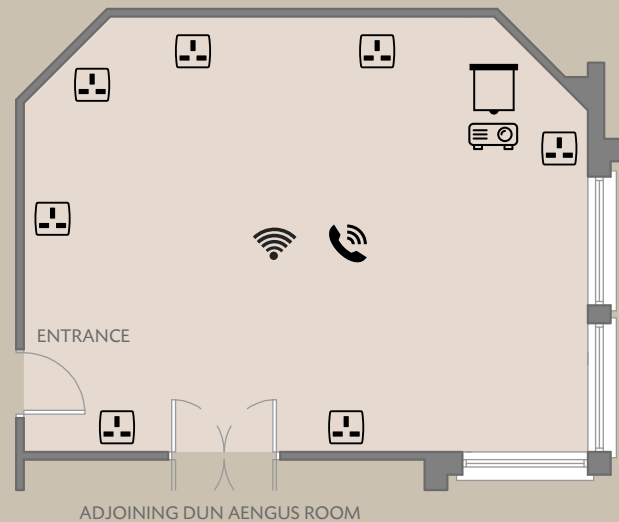

THEATRE	40
BOARDROOM	20
CLASSROOM	24
U-SHAPE	15
BANQUET	N/A
EXAM	12
RECEPTION	25
CABARET	20
SEMI-CIRCLE	25
CIRCLE	25



KEY TO SERVICES

- SCREEN
- LCD PROJECTOR
- PHONE LINE
- PODIUM
- AIR CONDITIONING
- 3 PHASE POWER
- POWER SOCKETS
- WIFI WIRELESS BB
- MIC / AUDIO
- PC PORT

BALLYCURRAN ROOM

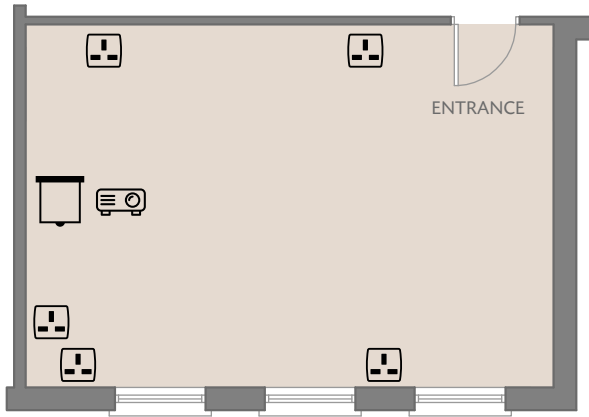

THEATRE	40
BOARDROOM	20
CLASSROOM	20
U-SHAPE	22
BANQUET	N/A
EXAM	8
RECEPTION	25
CABARET	20
SEMI-CIRCLE	20
CIRCLE	20

DIMENSIONS

Room Area 5.8m X 7.2m
Door Height 2.02m

Ceiling Height 2.61m
Door Width 0.76m



BOARDROOM

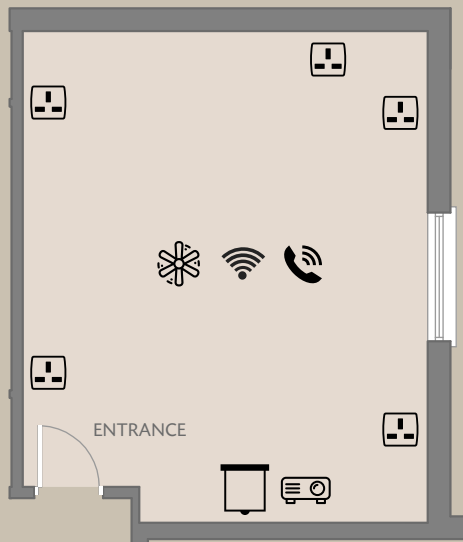

THEATRE	N/A
BOARDROOM	14
CLASSROOM	N/A
U-SHAPE	N/A
BANQUET	N/A
EXAM	N/A
RECEPTION	N/A
CABARET	N/A
SEMI-CIRCLE	N/A
CIRCLE	N/A

DIMENSIONS

Room Area 6.0m X 6.4m
Door Height 2.01m

Ceiling Height 2.61m
Door Width 0.75m



DUN AENGUS ROOM



THEATRE	20
BOARDROOM	12
CLASSROOM	12
U-SHAPE	10
BANQUET	N/A
EXAM	6
RECEPTION	15
CABARET	8
SEMI-CIRCLE	10
CIRCLE	10

DIMENSIONS

Room Area 5.05m X 5.25m Ceiling Height 2.72m Door Height 2.02m Door Width 1.59m

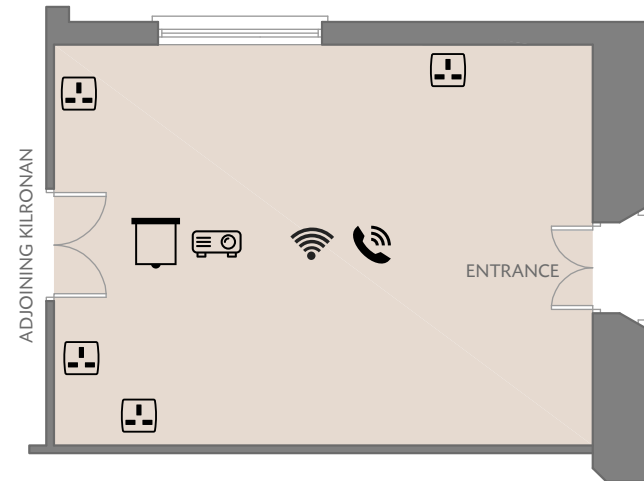

MEETING ROOM SET-UP STYLES

THEATRE

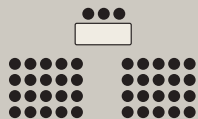

BANQUET

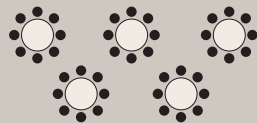

RECEPTION / CASUAL

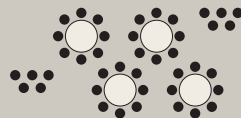

CABARET

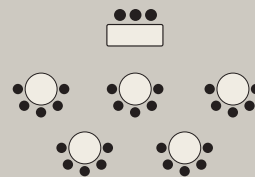

BOARDROOM



CLASSROOM

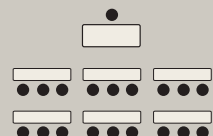

U-STYLE

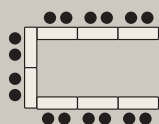

SEMI-CIRCLE

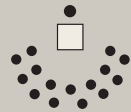

CIRCLE



THEATRE

Rows of chairs facing the front of the room. Appropriate for short talks or larger groups that do not require extensive note-taking.

BANQUET

Round tables, trestle tables and / or block tables (dependant on event numbers) set for meal events.

RECEPTION / CASUAL

Used for finger food / canapé functions. Standard tables and / or smaller round pod tables and some seating scattered throughout the room.

CABARET

Popular with training sessions, working lunch or team workshops. Round tables set leaving an open end in order that all delegates seated are facing front of room.

BOARDROOM

Conference table with chairs placed around the perimeter.

CLASSROOM

Rows of tables with chairs at each one facing the front of the room. Most desirable for long lectures where there is extensive note-taking.

U STYLE

Tables placed in the room to form a U shape with chairs around the outside of the U.

SEMI-CIRCLE

Semi-Circle is a variant of the U Shape but without tables. Ideal for small to medium groups with a discussion or teaching format where little or no writing is required and participation is encouraged.

CIRCLE

Circle of chairs. Ideal for small to medium groups with a discussion or teaching format where little or no writing is required and participation is encouraged.

GUEST ACCOMMODATION

Standard Rooms

Superior Rooms

Deluxe Rooms

Suites

Triple Rooms

Family Rooms

Rooms suitable for guests
with special needs

We provide...

Utmost Comfort

Complimentary Wi-Fi

Room Service

Laundry and Dry Cleaning Service

Safety Deposit Box

Wake-Up Call Service



ARDILAUN DINING

Experience formal dining in the Camilaun Dining Room, more casual dining in The Ardilaun Bistro, enjoy a BBQ in the beautifully landscaped gardens or relax with a coffee in the comfortable foyer. Private room dining also available.

The events team are very happy to assist you with options and advice in line with your event requirements and to provide you with sample menus for consideration.

The Ardilaun can cater for any meeting type to include breakfast, brunch, lunch, finger food, buffet or dinner. Alternatively the events team can discuss specific preferences with you and are happy to customise.



RELAX AND BE PAMPERED

From improved mental health to sharper decision-making, a fitter workforce can make a big difference to your business. At The Ardilaun Leisure Club, the experience is in keeping members motivated and feeling fit - let the team help your employees do the same.

Relax in the Sauna or Steam room, soak up the bubbles in the Jacuzzi or if feeling more energetic, take pleasure in using the state of the art fully equipped Gym and 18 Metre Pool or even take part in one of the Boot Camp classes.

Alternatively, you can choose to pamper, indulge, or simply relax and unwind at Avalon Beauty Salon. The dedicated, professional and friendly beauty therapists will provide you with a unique and superior pampering experience offering a wide range of treatments including massage, facial, body and beauty treatments, manicures, pedicures and pamper packages.



business card

☆☆☆☆
THE ARDILAUN
 Est. 1962



GPS Coordinates: 53.269354, -9.079218

Ardilaun Eircode: H91 H29F

ACCESS BY ROAD

A useful website to help plan your journey is www.aaireland.ie

ACCESS BY RAIL

The Ardilaun Hotel is situated 3 km from Galway Rail Station - www.irishrail.ie

The Ardilaun Hotel is situated 3 km from Galway Coach Station

ACCESS BY AIR

Ireland West Airport Knock located 1.5 hour drive (90km) from The Ardilaun Hotel

- www.knockairport.com

Shannon Airport located 1.5 hour drive (85km) from The Ardilaun Hotel -

www.shannonairport.com

Dublin Airport located 2.5 hour drive (215km) from The Ardilaun Hotel -

www.dublinairport.com



THE ARDILAUN HOTEL, TAYLORS HILL, GALWAY, IRELAND. T: +353 (0) 91 521433 E: EVENTS@THEARDILAUNHOTEL.IE WWW.THEARDILAUNHOTEL.IE

